

Original  
BMW Zubehör



Bedienungsanleitung

Freude am Fahren

**Bedienungsanleitung**  
**Operating instructions**  
**Mode d'emploi**  
**Bedieningshandleiding**  
**Bruksanvisning**  
**Manuale d'istruzioni**  
**Instrucciones de uso**  
**Manual de instruções operação**



**BMW Kamerasysteme**  
**BMW camera systems**  
**Systèmes de caméras BMW**  
**BMW camerasystemen**  
**BMW kamerasystem**  
**Sistemi telecamera BMW**  
**Sistemas de cámara BMW**  
**Sistemas de câmaras BMW**

© 2005 Bayerische Motoren Werke  
Aktiengesellschaft  
München / Deutschland  
Nachdruck, auch auszugsweise,  
nur mit schriftlicher Genehmigung der  
BMW AG, München.  
Bestell-Nr. 01 29 0 304 299  
VI/05 Z/Z  
Printed in Germany  
Gedruckt auf umweltfreundlichem Papier  
(chlorfrei gebleicht, wiederverwertbar).  
Druckfehler, Irrtümer und Änderungen vorbehalten.

### Contents

- 12** General information
  - Symbols used
- 12** Basic principle
- 12** Important information about operating the camera systems
  - General instructions for operating the front camera
  - General instructions for operating the rear-view camera
  - Instructions for operating the camera(s) in all 7 Series models built after 10/01
- 12** Care instructions
- 13** All cars except 7 Series models built after 10/01
  - To switch on the front camera
  - To switch off the front camera
  - To switch on the rear-view camera
  - To switch off the rear-view camera
- 14** 7 Series models built after 10/01 only
  - Basic settings
    - To remove help texts from the Assistance window
    - To move the navigation image to the Assistance window
  - Select the Navigation menu
  - Cars with Park Distance Control (PDC) only
    - To switch off the PDC image
    - To switch on the front camera
    - To switch off the front camera
    - To switch on the rear-view camera
    - To switch off the rear-view camera
- 16** 3 Series and 1 Series models with a separate monitor only
  - Adjust the monitor brightness
  - Distance from obstacles when reversing

## General information

BMW recommends to use only parts and accessories that have been tested and approved by BMW in terms of their safety, function and suitability.

### Symbols used



Denotes instructions of warnings that you must observe.



Denotes instructions that draw your attention to special features.

◀ Denotes the end of the instruction.

## Basic principle

Camera systems enable you to view the immediate area in front of and behind your car on the on-board monitor or the control display of your car. They assist you when parking and manoeuvring.

The cameras record the areas which the driver is unable to see and display them on the on-board monitor or the control display.

The rear-view camera records the area behind the car and the front-view camera records the area to the right and left in front of the car.

## Important information about operating the camera systems



Camera systems cannot replace your personal ability to judge obstacles. ▶

It takes a certain amount of time to get used to driving with a visual display. Careful driving is essential even when using the camera systems.

The camera lens may get dirty in adverse conditions such as rain, mud and snow, leading to the quality of the displayed image deteriorating.

## General instructions for operating the front camera

For safety reasons, the front camera cannot be switched on at speeds in excess of about 10 kph, and it switches itself off if the car is accelerated beyond this speed.

## General instructions for operating the rear-view camera

The camera image goes out after about 5 seconds when the rear-view camera is switched off.

## Instructions for operating the camera(s) in all 7 Series models built after 10/01

The camera image is only displayed in full in the navigation menu.

If the camera image is displayed incomplete slide the controller for the control display to the right into the navigation menu.

## Care instructions

Use a soft cloth for cleaning the camera lens and avoid using aggressive cleaning agents.

## All cars except 7 Series models built after 10/01

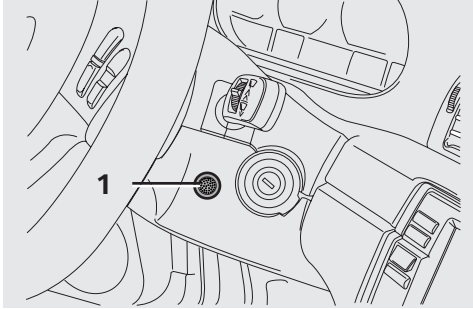

### To switch on the rear-view camera

- Engage reverse gear

The image from the rear-view camera is displayed on the on-board monitor.

### To switch off the rear-view camera

- Disengage reverse gear

The image from the rear-view camera will disappear from the on-board monitor after approx. 5 seconds.

The previous display is restored on the on-board monitor.

### To switch on the front camera

- Press the button (1)

The image from the front camera is displayed on the on-board monitor.

### To switch off the front camera

- Press the button (1)

The image from the front camera on the on-board monitor goes out.

The previous display is restored on the on-board monitor.

## 7 Series models built after 10/01 only

### Basic settings

You must make these basic settings before you can use the camera(s).

These basic settings involve adjusting the control display and only need to be done once.

 The camera image will not be displayed correctly unless you make these basic settings.

Refer to the owner's manual of the car for basic information about the function and operation of the control display. ◀

 Depending on the software version in your car, it may be necessary to hide the help texts in the assistance window. ◀

### To remove help texts from the Assistance window

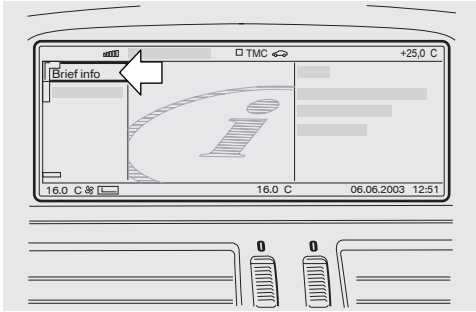

065 0474 Z

- Select **<HELP>** in the Orientation menu
- Deactivate **<Brief info>**

The help texts will now be hidden.

### To move the navigation image to the Assistance window

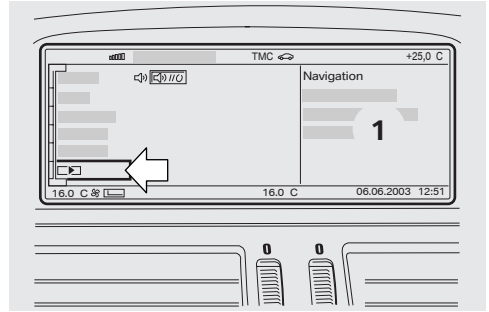

065 0556 Z

- Select **<Navigation>** in the Orientation menu
- Select the  symbol and confirm your selection

The navigation image will be displayed in the Assistance window (1).

### Select the Navigation menu

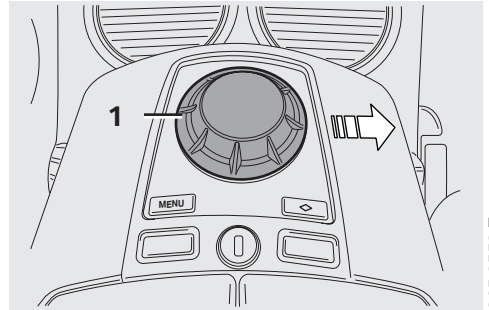

065 0558 Z

 The camera image is only displayed in full in the Navigation menu. ◀

- Slide the controller (1) to the right
- The Navigation menu is selected.

## Cars with Park Distance Control (PDC) only

You must switch of the PDC image before you can use the camera(s).

This additional setting involves adjusting the Park Distance Control (PDC) and only has to be completed once.

 The camera image will not be displayed correctly unless you make this additional setting.

Refer to the owner's manual of the car for basic information about the function and operation of the control display.

The PDC will now only be activated in acoustic mode even if you are not using the camera(s). ◀

## To switch off the PDC image

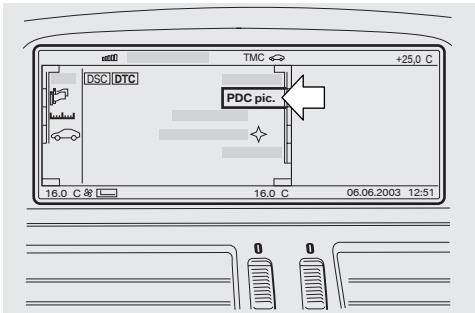



- Select **<SETTINGS>** in the Orientation menu
- Select **<PDC pic.>** and switch it off

The PDC image is switched off.

 The PDC will now only be switched on in acoustic mode even if you are not using the camera(s). ◀

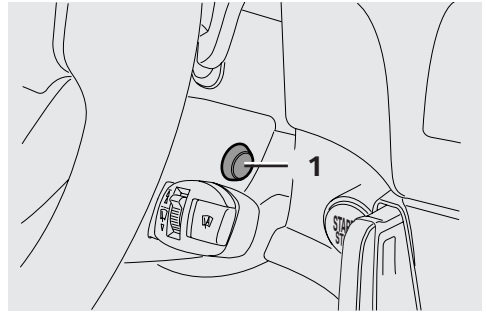
## To switch on the front camera



 Refer to the basic settings (page 14). The camera image is only displayed in full in the Navigation menu. ◀

- Press the button (1)

The image from the front camera is displayed on the control display.

## To switch off the front camera

- Press the button (1)

The image from the front camera on the control display goes out.

The previous display is restored on the control display.

## To switch on the rear-view camera

 Refer to the basic settings (page 14). The camera image is only displayed in full in the Navigation menu. ◀

- Engage reverse gear

The image from the rear-view camera is displayed on the control display.

## To switch off the rear-view camera

- Disengage reverse gear

The image from the rear-view camera will disappear from the control display after approx. 5 seconds.

The previous display is restored on the control display.

## 3 Series and 1 Series models with a separate monitor only

### Adjust the monitor brightness

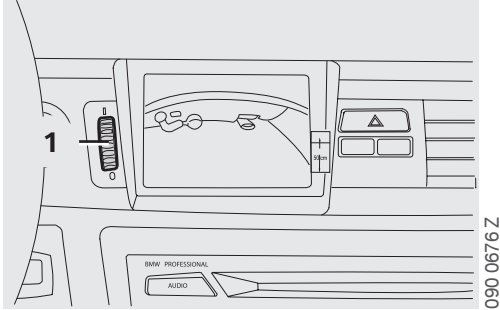

Turn the wheel (1) until the required brightness for the monitor image has been set.

### Distance to obstacles when reversing

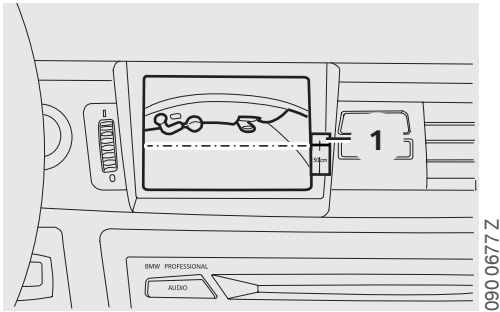

When an obstacle at the rear becomes level with the warning sticker (1), the distance between it and the rear of the car is approx. 50 cm.





Original  
BMW Zubehör



Bedienungsanleitung

Freude am Fahren

01 290 304 299